

# EmPOWER AI

ANNUAL CONFERENCE

*September 16 – 18, 2025*

HOST UTILITY



# WELCOME

We're delighted you've joined us in Napa Valley for EmPOWER AI 2025. Inside this packet, you'll find everything you need to navigate the conference—from session details to logistics and resources.

Over the next two days, you'll explore how AI is reshaping the energy landscape, hear fresh perspectives, and connect with peers who share your passion for innovation.

Most importantly, this event is about building connections and sparking ideas that continue well beyond our time together. Thank you for being part of this journey. We look forward to the conversations ahead.

With gratitude,  
the Bidgely Team

---

**If you need anything during the event,  
email Jessica at [jessica@bidgely.com](mailto:jessica@bidgely.com)**

---





# EVENT OVERVIEW

## TUESDAY SEPTEMBER 16

- 2:00 PM Invitation Only Executive Roundtable  
*Ashes & Diamonds*
- 4:00 PM Invitation Only Executive Wine Experience  
*Ashes & Diamonds*
- 7:00 PM Welcome Reception  
*Silverado Resort Mansion Lawn*

## WEDNESDAY SEPTEMBER 17

- 7:00 AM Breakfast  
*Fairyway Deck*
- 8:30 AM Mainstage Sessions  
*Silverado East*
- 11:45 AM Lunch  
*Fairway Deck*
- 1:10 PM Mainstage Sessions  
*Silverado East*
- 3:00 PM Breakout Sessions  
*Sterling Room; Joseph Phelps Room*
- 6:30 PM Roaring 20s Dinner Under the Stars  
*The Arbor*
- 8:30 PM Secret Speakeasy Afterparty  
*Royal Oak Room*

## THURSDAY SEPTEMBER 18

- 7:30 AM Breakfast  
*Fairyway Deck*
- 9:00 AM Mainstage Sessions  
*Silverado East*
- 12:15 PM Lunch  
*Fairway Deck*
- 1:45 PM Transportation  
*to SFO or Invitation Only Speakers Excursion*
- 2:00 PM Invitation Only Speakers Excursion  
*Darioush Winery*





# EMPOWER AI AGENDA: DAY 1

WEDNESDAY, SEPTEMBER 17

7:00AM	BREAKFAST OPENS	
8:30AM	<b>EMPOWER AI WELCOME ADDRESS</b>	Sean Wisdom, Bidgely Gautam Aggarwal, Bidgely
8:45AM	<b>CEO GREETING</b>	Abhay Gupta, Bidgely
9:00AM	<b>MOVING CUSTOMERS FROM THE EDGE OF THE GRID TO THE CENTER OF INNOVATION</b> <i>Using AI to make the grid dynamic, responsive, and customer-first.</i>	Ted Nielsen, Bidgely
9:40AM	<b>SCALING UTILITY AI FOR IMPACT</b>	Karthik Moorthy, Bidgely Srikanth Srinivasan, Infosys Don McDonnell, AWS Venkata Nimmala, APS
10:15AM	BREAK	
10:30AM	<b>CX+</b> <i>Designing dynamic &amp; personalized customer experience with AI.</i>	Hannah Courtney, Bidgely Nayan Parikh, PSEG Long Island Lori Boyer, TEP
11:10AM	<b>SMARTER LOAD, SMARTER SPEND: REIMAGINING TOU AND RATE DESIGN WITH SEGMENTATION</b> <i>How smarter segmentation and targeting drives better load shaping, rate fit, and program ROI.</i>	Jessica King, OGE Maddie Emerson, TRC Nathan Shannon, SECC Stevie Rosen, Bidgely
11:45AM	LUNCH	
1:10PM	<b>ICEBREAKER: NEURAL NETWORKING</b> <i>Quick connections with your fellow innovators.</i>	
1:20PM	<b>DISTRIBUTION GRID PLANNING: FORECASTING &amp; PREPAREDNESS FOR 10X GROWTH</b> <i>What it takes to future-proof the grid for an electrified future.</i>	Atousa Yazdani, SMUD Gregory Mandelman, EPE Maria Kretzing, Bidgely
2:00PM	<b>ACCELERATING EV PROGRAM SUCCESS WITH AI: PARTICIPATION, PRECISION, AND CUSTOMER-CENTRIC IMPACT</b> <i>Building flexible, future-ready EV strategies that meet utility goals across planning, operations, and customer engagement.</i>	Adam Grant, NV Energy Shawn Grant, Pacificorp Stevie Rosen, Bidgely
2:40PM	BREAK	
3:00PM	<b>BREAKOUT SESSION: UNLOCKING GRID POTENTIAL</b> <i>EV &amp; Grid - AWB User Group - Sterling Room</i>	Maria Kretzing, Bidgely Stevie Rosen, Bidgely
3:00PM	<b>BREAKOUT SESSION: EMPOWERING CUSTOMERS</b> <i>CX Roundtable - Joseph Phelps Room</i>	Darleen DeRosa, Bidgely Hannah Courtney, Bidgely
6:30PM	<b>DINNER UNDER THE STARS</b> <i>The Arbor</i>	
8:30PM	<b>SECRET SPEAKEASY AFTERPARTY</b> <i>Royal Oak Room</i>	



# EMPOWER AI AGENDA: DAY 2

THURSDAY, SEPTEMBER 18

7:30AM	BREAKFAST OPENS	
8:00AM	<b>BETTER TOGETHER</b> <i>The Bidgely Partner Network</i>	
9:00AM	<b>WELCOME</b>	Sean Wisdom, Bidgely Ted Nielsen, Bidgely
9:10AM	<b>BUILDING THE SUPERINTELLIGENT UTILITY</b>	Arvind Jain, Glean Abhay Gupta, Bidgely Ted Nielsen, Bidgely
9:50AM	<b>GLOBAL PERSPECTIVES: INDIA'S ENERGY STACK</b> <i>A national blueprint for utility intelligence.</i>	Nagasrikanth Kallakuri, FSR Global
10:20AM	BREAK	
10:50AM	<b>FROM AMI TO AI: DESIGNING FOR THE FUTURE WITH DISTRIBUTED INTELLIGENCE</b> <i>Why AMI 2.0 and distributed intelligence mark a new era for CX, EVs, and AI-powered utility strategy.</i>	Stefan Zschiegner, Itron Inc Abhay Gupta, Bidgely
11:30AM	<b>EVOLVING LOW-TO-MODERATE INCOME (LMI) &amp; AFFORDABILITY: THE NEW FRONTIER OF USING DATA TO BETTER SERVE CUSTOMERS</b> <i>How AI can unlock energy savings, elevate underserved voices, and keep people at the center of utility decision making.</i>	Kristol Simms, Ameren Andrew Bevington, San Francisco Public Utilities Commission Darleen DeRosa, Bidgely
12:10PM	<b>CLOSING REMARKS</b>	Sean Wisdom, Bidgely
12:15PM	LUNCH	
1:45PM	<b>TRANSPORTATION</b> <i>To San Francisco Airport or Speakers Excursion</i>	
2:00PM	<b>SPEAKERS EXCURSION: DARIOUSH WINERY</b> <i>Invitation Only</i>	

Layers of espresso-soaked ladyfingers,  
mascarpone, and cocoa powder





## WINE SHIPMENT

As part of your stay, you'll find a bottle of wine waiting in your room — a small gift of appreciation from us. We hope you enjoy it during the event, or save it to savor later.

If you'd prefer to bring your bottle home, we're pleased to offer complimentary shipping:

- **Visit the Front Desk to pick up a short shipping form**
- **Complete the form at your convenience**
- **Leave your wine and form with the Front Desk team**

We'll ensure your bottle is carefully packaged and shipped directly to your home, with our compliments.

---

## THOUGHT-LEADERSHIP FILMING

We'd love to feature your perspectives for our EmPOWER thought-leadership series.

**If you have not yet scheduled**, please [schedule a session here](#).

Filming lasts 30 minutes. The location will be confirmed via text at least 15 minutes before your scheduled session. To see what the interviews are like, watch a [previous year's highlights](#) for a glimpse of how we showcase attendee voices.

You'll be asked the following type of questions:

- **Insights on key themes.**
- **Highlights from your speaking session.**
- **Reflections on EmPOWER AI.**

*Please note: as always, you will be given the opportunity to review & approve everything produced featuring you.*



# SILVERADO MANSION MAP

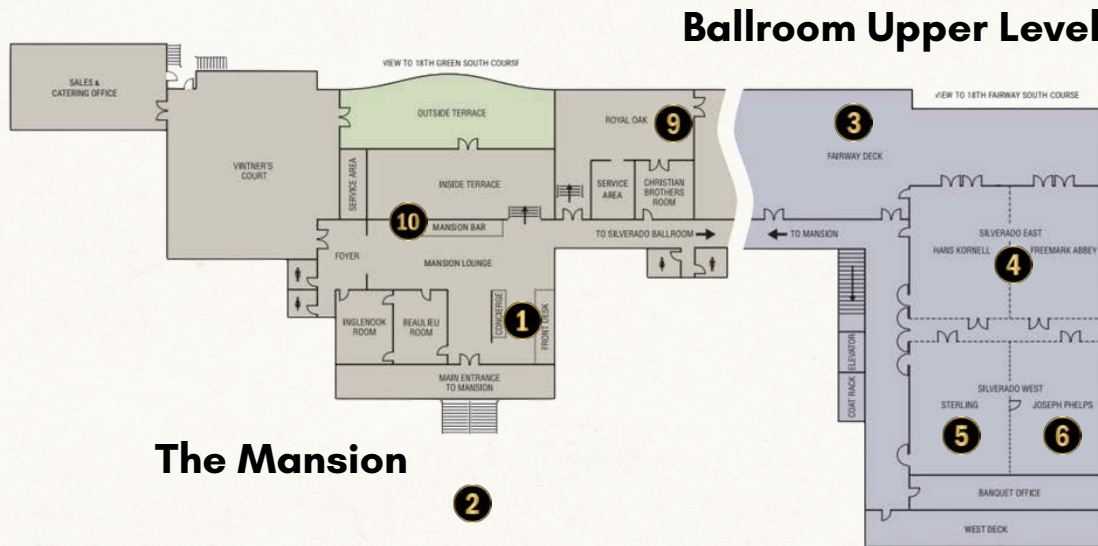

## Ballroom Lower Level

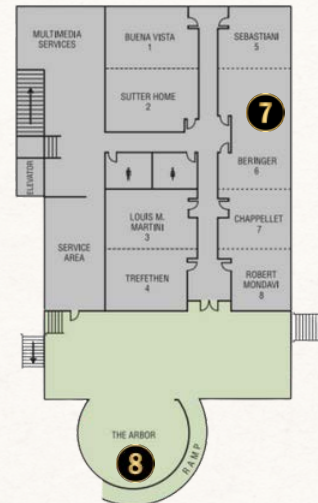

- 1 Front Desk & Concierge**
- 2 Mansion Front Lawn, Welcome Reception**
- 3 Fairway Deck, Breakfast & Lunch**
- 4 Ballroom, Mainstage**
- 5 Sterling, Breakout Room**
- 6 Joseph Phelps, Breakout Room**
- 7 Beringer, Meeting Room - [reservation link](#)**
- 8 Arbor, Dinner Under the Stars**
- 9 Royal Oak, Secret Speakeasy Afterparty**
- 10 Mansion Bar & Terrace**



# SILVERADO RESORT AMENITIES



## Resort Pool

Relax at the resort's heated outdoor pool.

Open daily 9:00 AM – 8:00 PM



## Award Winning Golf Course

Exclusively available to Silverado Resort guests and members.

Book a tee time: 707-257-5460



## Tennis, Pickle Ball, & Bocce Ball

Tennis Office: 707-257-5541

Reserve Bocce: 707- 257-5555



## The Spa at Silverado

EmPOWER AI guests receive a **10% discount**.

Call to book: 800-532-0500

 [Spa Menu](#)



## Fitness Center

Open daily 6:00 AM – 7:00 PM

 [Daily Classes](#)

***Please note:*** resort charges and incidentals incurred are the responsibility of the guest and are not included as part of the EmPOWER AI Annual Conference.